



Report of: **Service Director, Public Protection**

Meeting of	Date	Agenda Item	Ward(s)
Licensing Sub-Committee	27 th August 2015		Mildmay

Delete as appropriate		Non-exempt
------------------------------	--	------------

Subject: PREMISES LICENCE NEW APPLICATION
PIZZA TAKE AWAY, UNIT A, CHARLES MORTON COURT, 37 GREEN LANES, LONDON, N16 9BS

1. Synopsis

- 1.1 This is an application for a new premise licence under the Licensing Act 2003.
- 1.2 The new application is to allow:
 - The provision of late night refreshment, Sundays to Thursdays from 23:00 until 00:00 and Fridays & Saturdays from 23:00 until 01:30 the following day.

2. Relevant Representations

Licensing Authority	No
Metropolitan Police	No
Noise	No
Health and Safety	No
Trading Standards	No
Public Health	No

Safeguarding Children	No
London Fire Brigade	No
Local residents	Yes: Four local residents.
Other bodies	No:

3. Background

3.1 Papers are attached as follows:

- Appendix 1: application form;
- Appendix 2: representations;
- Appendix 3: suggested conditions and map of premises location.

4. Planning Implications

4.1 Relevant Planning History:

Planning permission p080221 dated 19 March 2008

Change of use from A1 (retail) to A5 (hot food take away)

Restrictive conditions

The use shall not operate except between the hours of 0800 and 2300 on any day.

To ensure that the proposed development does not prejudice the enjoyment by neighbouring occupiers of their premises.

5 Recommendations

5.1 To determine the application for a new premises licence under Section 17 of the Licensing Act 2003.

5.2 If the Committee grants the application it should be subject to:

- i. conditions prepared by the Licensing Officer which are consistent with the Operating Schedule (see appendix 3)
- ii. any conditions deemed appropriate by the Committee to promote the four licensing objectives.(see appendix 3)
- iii. any conditions deemed necessary by the Committee to promote the four licensing objectives.

6 Conclusion and reasons for recommendations

6.1 The Council is required to consider this application in the light of all relevant information, and if approval is given, it may attach such conditions as appropriate to promote the licensing objectives.

Background papers:

The Council's Statement of Licensing Policy
Licensing Act 2003
Secretary of States Guidance

Final Report Clearance

Signed by

Service Director – Public Protection

17-8-15

Date

Received by

Head of Scrutiny and Democratic Services

Date

Report author: Licensing Service

Tel: 020 75027 3031

E-mail: licensing@islington.gov.uk

wk/2015 90826

Appendix 1

Islington
Application for a premises licence
Licensing Act 2003

For help contact
licensing@islington.gov.uk
Telephone: 020 7527 3031

ISLINGTON

* required information

Section 1 of 19

You can save the form at any time and resume it later. You do not need to be logged in when you resume.

System reference This is the unique reference for this application generated by the system.

Your reference You can put what you want here to help you track applications if you make lots of them. It is passed to the authority.

Are you an agent acting on behalf of the applicant?

Yes No

Put "no" if you are applying on your own behalf or on behalf of a business you own or work for.

Applicant Details

* First name

* Family name

* E-mail

Main telephone number Include country code.

Other telephone number

Indicate here if you would prefer not to be contacted by telephone

Are you:

Applying as a business or organisation, including as a sole trader

Applying as an individual

A sole trader is a business owned by one person without any special legal structure. Applying as an individual means you are applying so you can be employed, or for some other personal reason, such as following a hobby.

Applicant Business

* Is your business registered in the UK with Companies House? Yes No

* Registration number

* Business name If your business is registered, use its registered name.

* VAT number Put "none" if you are not registered for VAT.

* Legal status

IP2/465244
£190.00/ELMS
29/06/15

Continued from previous page...

* Your position in the business

Home country

The country where the headquarters of your business is located.

Registered Address

Address registered with Companies House.

* Building number or name

* Street

District

* City or town

County or administrative area

* Postcode

* Country

Section 2 of 19

PREMISES DETAILS

I/we, as named in section 1, apply for a premises licence under section 17 of the Licensing Act 2003 for the premises described in section 2 below (the premises) and I/we are making this application to you as the relevant licensing authority in accordance with section 12 of the Licensing Act 2003.

Premises Address

Are you able to provide a postal address, OS map reference or description of the premises?

Address OS map reference Description

Postal Address Of Premises

Building number or name

Street

District

City or town

County or administrative area

Postcode

Country

Further Details

Telephone number

Non-domestic rateable value of premises (£)

Section 3 of 19

APPLICATION DETAILS

In what capacity are you applying for the premises licence?

- An individual or individuals
- A limited company
- A partnership
- An unincorporated association
- A recognised club
- A charity
- The proprietor of an educational establishment
- A health service body
- A person who is registered under part 2 of the Care Standards Act 2000 (c14) in respect of an independent hospital in Wales
- A person who is registered under Chapter 2 of Part 1 of the Health and Social Care Act 2008 in respect of the carrying on of a regulated activity (within the meaning of that Part) in an independent hospital in England
- The chief officer of police of a police force in England and Wales
- Other (for example a statutory corporation)

Confirm The Following

- I am carrying on or proposing to carry on a business which involves the use of the premises for licensable activities
- I am making the application pursuant to a statutory function
- I am making the application pursuant to a function discharged by virtue of Her Majesty's prerogative

Section 4 of 19

NON INDIVIDUAL APPLICANTS

Provide name and registered address of applicant in full. Where appropriate give any registered number. In the case of a partnership or other joint venture (other than a body corporate), give the name and address of each party concerned.

Non Individual Applicant's Name

Name

Details

Registered number (where applicable)

Description of applicant (for example partnership, company, unincorporated association etc)

Continued from previous page...

Incorporated Company

Address

Building number or name

Street

District

City or town

County or administrative area

Postcode

Country

Contact Details

E-mail

Telephone number

Other telephone number

Section 5 of 19

OPERATING SCHEDULE

When do you want the premises licence to start? / /
dd mm yyyy

If you wish the licence to be valid only for a limited period, when do you want it to end / /
dd mm yyyy

Provide a general description of the premises

For example the type of premises, its general situation and layout and any other information which could be relevant to the licensing objectives. Where your application includes off-supplies of alcohol and you intend to provide a place for consumption of these off- supplies you must include a description of where the place will be and its proximity to the premises.

Pizza Delivery & Takeaway

If 5,000 or more people are expected to attend the premises at any one time, state the number expected to attend

Continued from previous page...

Section 6 of 19

PROVISION OF PLAYS

Will you be providing plays?

- Yes No

Section 7 of 19

PROVISION OF FILMS

Will you be providing films?

- Yes No

Section 8 of 19

PROVISION OF INDOOR SPORTING EVENTS

Will you be providing indoor sporting events?

- Yes No

Section 9 of 19

PROVISION OF BOXING OR WRESTLING ENTERTAINMENTS

Will you be providing boxing or wrestling entertainments?

- Yes No

Section 10 of 19

PROVISION OF LIVE MUSIC

Will you be providing live music?

- Yes No

Section 11 of 19

PROVISION OF RECORDED MUSIC

Will you be providing recorded music?

- Yes No

Section 12 of 19

PROVISION OF PERFORMANCES OF DANCE

Will you be providing performances of dance?

- Yes No

Section 13 of 19

PROVISION OF ANYTHING OF A SIMILAR DESCRIPTION TO LIVE MUSIC, RECORDED MUSIC OR PERFORMANCES OF DANCE

Will you be providing anything similar to live music, recorded music or performances of dance?

- Yes No

Section 14 of 19

LATE NIGHT REFRESHMENT

Will you be providing late night refreshment?

Standard Days And Timings

MONDAY

Start

End

Start

End

Give timings in 24 hour clock. (e.g., 16:00) and only give details for the days of the week when you intend the premises to be used for the activity.

TUESDAY

Start

End

Start

End

WEDNESDAY

Start

End

Start

End

THURSDAY

Start

End

Start

End

FRIDAY

Start

End

Start

End

SATURDAY

Start

End

Start

End

SUNDAY

Start

End

Start

End

Will the provision of late night refreshment take place indoors or outdoors or both?

Indoors

Outdoors

Both

Where taking place in a building or other structure tick as appropriate. Indoors may include a tent.

State type of activity to be authorised, if not already stated, and give relevant further details, for example (but not exclusively) whether or not music will be amplified or unamplified.

Pizza Delivery & Takeaway

State any seasonal variations

Continued from previous page...

For example (but not exclusively) where the activity will occur on additional days during the summer months.

Non-standard timings. Where the premises will be used for the supply of late night refreshments at different times from those listed in the column on the left, list below

For example (but not exclusively), where you wish the activity to go on longer on a particular day e.g. Christmas Eve.

New Years Eve & New Years Day 23;00 - 04:00

Section 15 of 19

SUPPLY OF ALCOHOL

Will you be selling or supplying alcohol?

- Yes
- No

PROPOSED DESIGNATED PREMISES SUPERVISOR CONSENT

How will the consent form of the proposed designated premises supervisor be supplied to the authority?

- Electronically, by the proposed designated premises supervisor
- As an attachment to this application

Reference number for consent form (if known)

If the consent form is already submitted, ask the proposed designated premises supervisor for its 'system reference' or 'your reference'.

Section 16 of 19

ADULT ENTERTAINMENT

Highlight any adult entertainment or services, activities, or other entertainment or matters ancillary to the use of the premises that may give rise to concern in respect of children

Give information about anything intended to occur at the premises or ancillary to the use of the premises which may give rise to concern in respect of children, regardless of whether you intend children to have access to the premises, for example (but not exclusively) nudity or semi-nudity, films for restricted age groups etc gambling machines etc.

none

Section 17 of 19

HOURS PREMISES ARE OPEN TO THE PUBLIC

Standard Days And Timings

Continued from previous page...

MONDAY

Start

End

Start

End

Give timings in 24 hour clock.
(e.g., 16:00) and only give details for the days
of the week when you intend the premises
to be used for the activity.

TUESDAY

Start

End

Start

End

WEDNESDAY

Start

End

Start

End

THURSDAY

Start

End

Start

End

FRIDAY

Start

End

Start

End

SATURDAY

Start

End

Start

End

SUNDAY

Start

End

Start

End

State any seasonal variations

For example (but not exclusively) where the activity will occur on additional days during the summer months.

Non standard timings. Where you intend to use the premises to be open to the members and guests at different times from those listed in the column on the left, list below

For example (but not exclusively), where you wish the activity to go on longer on a particular day e.g. Christmas Eve.

New years Eve & new years Day 10:00 - 04:00

Continued from previous page...

Section 18 of 19

LICENSING OBJECTIVES

Describe the steps you intend to take to promote the four licensing objectives:

a) General – all four licensing objectives (b,c,d,e)

List here steps you will take to promote all four licensing objectives together.

We have trained all staff to understand the four licensing objectives, we will put up notices for our customers to leave the premises quietly, we will set a regular litter patrol around the shop for rubbish, we will monitor activity through CCTV to ensure public safety

b) The prevention of crime and disorder

We have installed CCTV systems to record and monitor activity, the police and other law enforcement agencies will have access, staff have had internal training on tackling disorderly customers

c) Public safety

We have installed CCTV systems that the police can use, we will ensure that disabled users are given appropriate help. We will not engage in any activity that may put the public at risk

d) The prevention of public nuisance

We respect our neighbors and will keep the street clean of litter and keep noise to a minimum and ask customers to do the same

e) The protection of children from harm

The staff on duty will take special notice and care of children whilst they are on premises

Section 19 of 19

PAYMENT DETAILS

This fee must be paid to the authority. If you complete the application online, you must pay it by debit or credit card.

Premises Licence Fees are determined by the non domestic rateable value of the premises.

To find out a premises non domestic rateable value go to the Valuation Office Agency site at http://www.voa.gov.uk/business_rates/index.htm

Band A - No RV to £4300	£100.00
Band B - £4301 to £33000	£190.00
Band C - £33001 to £87000	£315.00
Band D - £87001 to £125000	£450.00*
Band E - £125001 and over	£635.00*

*If the premises rateable value is in Bands D or E and the premises is primarily used for the consumption of alcohol on the

Continued from previous page...

premises then you are required to pay a higher fee

Band D - £87001 to £125000	£900.00
Band E - £125001 and over	£1,905.00

There is an exemption from the payment of fees in relation to the provision of regulated entertainment at church halls, chapel halls or premises of a similar nature, village halls, parish or community halls, or other premises of a similar nature. The costs associated with these licences will be met by central Government. If, however, the licence also authorises the use of the premises for the supply of alcohol or the provision of late night refreshment, a fee will be required.

Schools and sixth form colleges are exempt from the fees associated with the authorisation of regulated entertainment where the entertainment is provided by and at the school or college and for the purposes of the school or college.

If you operate a large event you are subject to ADDITIONAL fees based upon the number in attendance at any one time

Capacity 5000-9999	£1,000.00
Capacity 10000 -14999	£2,000.00
Capacity 15000-19999	£4,000.00
Capacity 20000-29999	£8,000.00
Capacity 30000-39999	£16,000.00
Capacity 40000-49999	£24,000.00
Capacity 50000-59999	£32,000.00
Capacity 60000-69999	£40,000.00
Capacity 70000-79999	£48,000.00
Capacity 80000-89999	£56,000.00
Capacity 90000 and over	£64,000.00

* Fee amount (£)

DECLARATION

* I/we understand it is an offence, liable on conviction to a fine up to level 5 on the standard scale, under section 158 of the licensing act 2003, to make a false statement in or in connection with this application.

Ticking this box indicates you have read and understood the above declaration

This section should be completed by the applicant, unless you answered "Yes" to the question "Are you an agent acting on behalf of the applicant?"

* Full name

* Capacity

* Date / /
dd mm yyyy

Once you're finished you need to do the following:

1. Save this form to your computer by clicking file/save as...
2. Go back to <https://www.gov.uk/apply-for-a-licence/premises-licence/islington/apply-1> to upload this file and continue with your application.

Don't forget to make sure you have all your supporting documentation to hand.

IT IS AN OFFENCE, LIABLE ON SUMMARY CONVICTION TO A FINE NOT EXCEEDING LEVEL 5 ON THE STANDARD SCALE, UNDER SECTION 158 OF THE LICENSING ACT 2003, TO MAKE A FALSE STATEMENT IN OR IN CONNECTION WITH THIS APPLICATION

OFFICE USE ONLY

Applicant reference number

Fee paid

Payment provider reference

ELMS Payment Reference

Payment status

Payment authorisation code

Payment authorisation date

Date and time submitted

Approval deadline

Error message

Is Digitally signed

< Previous 1 2 3 4 5 6 7 8 9 10 11 12 13 14 15 16 17 18 19 Next >

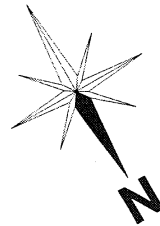
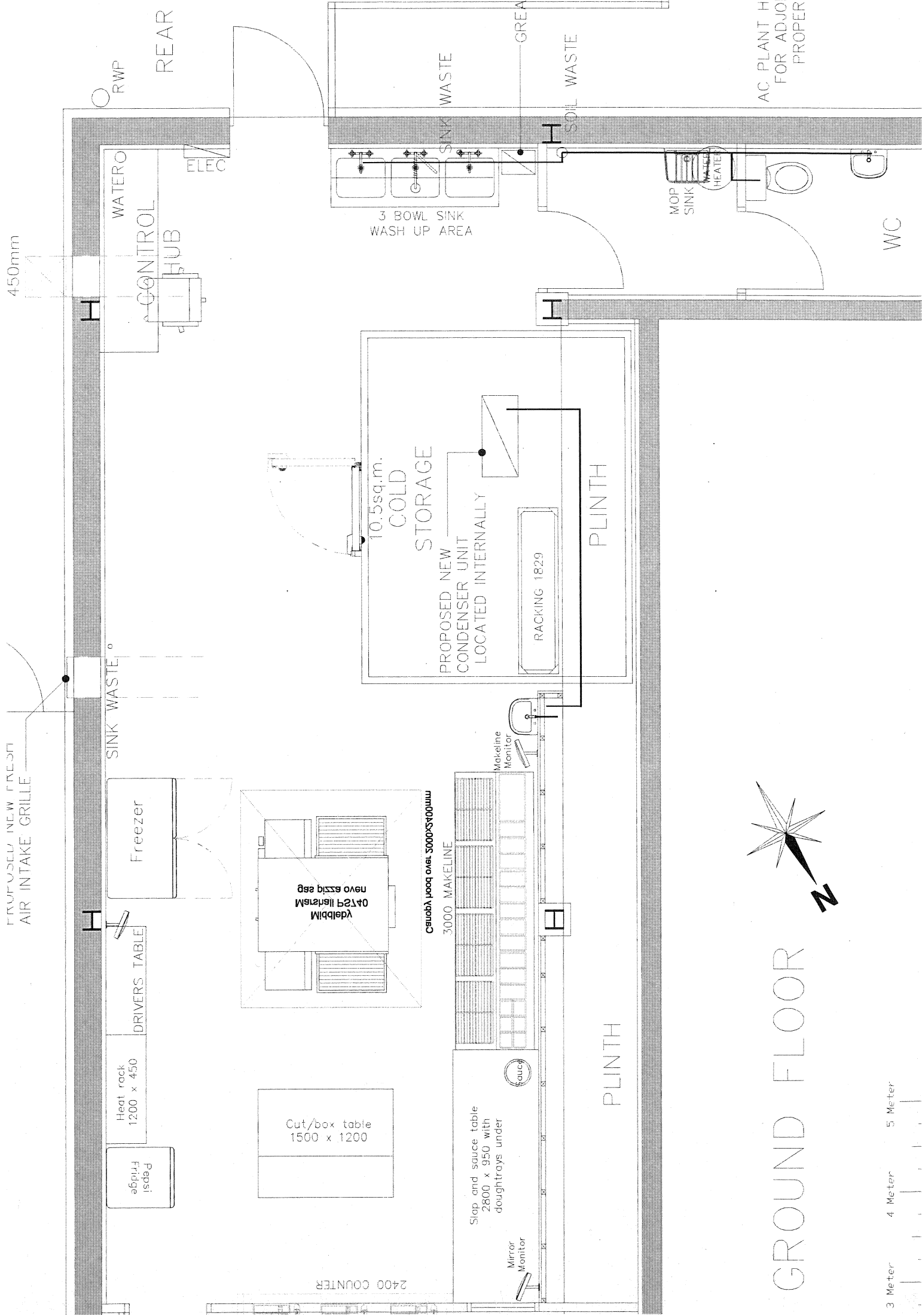

GROUND FLOOR



Licensing Act 2003 representation pro-forma

Should you wish to comment on the licence application please use this form to help you. Please feel free to attach additional sheets.

You do not have to make any comment, and comments may be made in support of as well as against the application, providing they refer to one or more of the licensing objectives (please see the guidance notes for further advice).

Premises Name and address:

Pizza Takeaway, Unit A, Charles Morton Court, 37 Green Lanes, Islington, London, N16 9BS

Your Name:

Interest:

Resident

(E.g. resident, business, TRA Chair, Councillor, solicitor)

Your Address:

Email:

Telephone:

Please comment on the licensing objectives below relevant to your concerns or observations, you may also wish to include suggestions how your concerns could be addressed:

Public Nuisance

The area outside the property is already very untidy with inappropriate refusal for the waste that Tesco produce. I am concerned that this will get worse with the disposal nature of the products that the pizza shop sell. To combat this I think that the applicant should have to pay for more bins outside the store, and ii) regular street cleaning (it is too infrequent at present). I am also concerned about intoxicated people (x)

Crime and Disorder

(x) behaving in an anti-social manner outside the store in the pursuit of food. I therefore object to the Sunday - Thursday late notice (11pm is late enough).

Protection of Children from Harm

Public Safety

I wish my identity to be kept anonymous: Yes No

We will treat representations as anonymous where there is a genuine reason to do so; if you wish your name and address details to be withheld then please explain the reason:

Copies of this representation will be sent to the applicant, or their agent/solicitor, including name and address details (but other personal contact information such as telephone numbers and email addresses will be removed) unless you have specifically requested anonymity. Copies of this representation will be included in a report that will be available to the public and will be published on the internet; however the published on-line version of the report will have name and address details removed.

Date:

13/7/15

Please ensure name and address details completed above

Return to:

Licensing Service
London Borough of Islington
3rd Floor
222 Upper Street
London N1 1XR

or send by email to:

licensing@islington.gov.uk

2

Fitzsimons, Aiden

From: Whitton, Daniel
Sent: 29 July 2015 10:23
To: Fitzsimons, Aiden
Subject: FW: F.A.O. Dan Whitton, R.E. PIZZA TAKEAWAY, 37 Green Lanes N16 9BS, WK/201590826- objection

From: Licensing
Sent: 24 July 2015 13:58
To: Whitton, Daniel
Subject: FW: F.A.O. Dan Whitton, R.E. PIZZA TAKEAWAY, 37 Green Lanes N16 9BS, WK/201590826- objection

From:
Sent: 23 July 2015 20:30
To: Licensing
Subject: F.A.O. Dan Whitton, R.E. PIZZA TAKEAWAY, 37 Green Lanes N16 9BS, WK/201590826- objection

Dear Mr Whitton,

R.E. WK/201590826- Pizza Takeaway, Unit A, Charles Morton Court, 37 Green Lanes N16 9BS, application for licence past 11pm

Having received notification of the above application from the council, it is with regret that we feel we must object, for the following reasons.

Public nuisance:

The property is surrounded by residential properties. There are many flats above, and there are many historic residential houses opposite inhabited by families with young children. It would create public nuisance for any of the commercial premises nearby to be allowed to open later than 11pm. Any premises serving alcohol past the bedtime of young children are undesirable. Late-night premises serving alcohol or even just takeaway food cause public nuisance, due to drunks arriving and leaving noisily, congregating outside while smoking, swearing, littering and acting in other even more antisocial ways such as fighting, public urination, trespass for the purposes of urination and sitting down to chat, and criminal damage. Late night venues attended by drunks also encourage begging and aggressive begging. The pavement could become blocked by drunk clientele smoking, drinking and congregating outside, forcing people to walk into the road on a street that attracts speeding at night. Once permission to open late has been granted, the council has no control over how popular and busy the premises become, so late-night disturbance becomes relatively unenforceable, no matter how earnestly the business owners ask their clientele to behave considerately.

Scooters stopping and starting their engines and going to and fro delivering pizzas will cause noise nuisance past 11pm. Their buzzy engines can be very irritating, so will disturb residents' sleep.

People who live in this neighbourhood do so because it is a relatively peaceful area. Many have families that they don't want to uproot and have a support network within the community that they don't want to leave. It would therefore be unfair to shatter this peace by allowing change that would increase public nuisance during the night.

The proposed hours of the premises past 11pm would likely cause excessive noise and disturbance at unsoiciable hours and would have a serious adverse effect on the amenities of the occupiers of the nearby residential properties.

Crime and disorder:

Late-night premises serving alcohol or even just takeaway food cause crime and disorder, due to drunks arriving and leaving noisily and congregating outside smoking thereby causing arguments with locals, littering, fighting, public urination, trespass for the purposes of urination and sitting down to chat, and criminal damage. Late night venues attended by drunks also encourage begging and aggressive begging. Areas where alcohol-related venues and takeaways are allowed to open after 11pm attract crime due to the antisocial level of inebriation of clientele past this hour.

People who live in this neighbourhood do so because it is a relatively safe area. Many have families that they don't want to uproot and have a support network within the community that they don't want to leave. It would therefore be unfair to reduce this safety by allowing change that would increase the local crime rate.

Protection of children from harm:

The property is surrounded by residential properties. There are many flats above, and there are many historic residential houses opposite inhabited by families with young children. Any premises serving alcohol past the bedtime of young children are therefore undesirable, and the children will face harm if alcohol-related venues and takeaways are allowed to open past 11pm.

Families have to live on this street because the properties in quieter back-streets are more expensive, so they can't just move to a back street without moving far away from their community support networks and the good schools here. Any increase in noise in the street at night, such as by drunks shouting and music playing from venues and the cars of commercial premises' clientele, would cause added detriment to the quality of local children's sleep at night, and thus affect their brain development and reduce their attention span and learning ability at school, directly harming their development and chances at gaining employment in later life, and stunting their ability to achieve health and happiness. They would be exposed to drunks shouting swear words frequently, which they may pick up, thus harming their future prospects and contribution to society. They would be exposed to other antisocial and scary behaviour, such as drunks urinating into their front gardens (as has happened before due to the late-night customers of the off-licenses here), and fighting (such as the pitch battle between one 'social club' and another recently on this street below a friend of our's flat, which ended with gunfire and a bullet being found in our friend's front door). Local children would no doubt grow up with a more negative view of society, having been raised surrounded by and over-exposed to antisocial inebriated people in their street at night, so they would be more likely in later life to become depressed, disaffected with society, or become one of the antisocial drunks themselves, and the more negative attitude they may foster by listening to such antisocial behaviour as they lie in bed could potentially increase their chances of becoming criminals in adulthood. The increase in stress from disturbed sleep and late-night antisocial behaviour would raise their cortisol levels in childhood, thereby giving them raised cortisol levels for life (as biology dictates), which means they would, throughout their lives, always be more stressed than a child who grew up without such disturbances. Increased stress levels are linked to increased cancer risk and heart problems. To allow venues to open past the reasonable, traditional social norm of 11pm in residential neighbourhoods such as this one is therefore tantamount to child abuse, in that it damages a child's brain and physical development, damages their future psychological wellbeing and physical health both in childhood and adulthood, and erodes their future prospects and contribution to society.

Many people who live in this neighbourhood do so because it is a good area for children. These families don't want to uproot themselves. They have a support network within the community that they don't want to leave. It is therefore unfair to push out families (push out those who are able to move, at least, and damage those who can't) by allowing change that would harm their children. Society can do without (and would probably be improved by the absence of) late-night drinking dens and takeaway outlets, but it can't do without a healthy and well-adjusted next generation.

Public Safety:

Late night premises serving alcohol or even just takeaway food are detrimental to public safety, due to drunks arriving and leaving noisily thereby causing arguments with locals, and drunks fighting between themselves. Locals feel an increased fear of physical danger from aggressive drunks when coming home at night. Late-night venues increase the fear of rape for local women when they arrive home at night, due to their being seen, propositioned, and sometimes even followed by drunk men congregating outside venues smoking or coming to and from such venues. The pavement could become blocked by drunk clientele smoking, drinking and congregating outside, forcing people to walk into the road on a street that attracts speeding at night.

People who live in this neighbourhood do so because it is a relatively safe area. Many have families that they don't want to uproot and have a support network within the community that they don't want to leave. It is therefore unfair to reduce this safety by allowing change that will reduce public safety in the area.

Our sleep is already disturbed at night by passers-by and customers of the commercial premises shouting in the street, playing music from their cars, and lorries loading and unloading, but thankfully at present the disturbance is just about manageable. There are already problems with littering and vandalism caused by passers-by,

loiterers, customers and the poor rubbish management of the commercial premises, but again these are just about manageable at present. We are very concerned, however, that allowing any more commercial premises on this street to stay open past 11pm will increase exponentially such problems in this residential area and make living here intolerable for local families.

Thank you for taking the time to consider our objection. We are very sorry to have to object and we hope the applicant can find it in their heart to understand and sympathise with our concerns.

Yours faithfully,

3

Licensing Act 2003 representation pro-forma

Should you wish to comment on the licence application please use this form to help you. Please feel free to attach additional sheets.

You do not have to make any comment, and comments may be made in support of as well as against the application, providing they refer to one or more of the licensing objectives (please see the guidance notes for further advice).

Premises Name and address:

Pizza Takeaway, Unit A, Charles Morton Court, 37 Green Lanes, Islington, London, N16 9BS

Your Name:

Interest:

LOCAL RESIDENT

(E.g. resident, business, TRA Chair, Councillor, solicitor)

Your Address:

Email:

Telephone:

Please comment on the licensing objectives below relevant to your concerns or observations, you may also wish to include suggestions how your concerns could be addressed:

Public Nuisance MY CONCERN IS THE EXTENDED OPENING HOURS UNTIL 01.30 ON FRIDAY & SATURDAY NIGHTS, CAUSING SLEEP DEPRIVATION DUE TO DRUNKS ARGUING & FIGHTING OUTSIDE THE SHOP & THE DELIVERY SCOOTERS RACING AROUND THE STREET. I DON'T BELIEVE THERE IS ANY REQUIREMENT FOR STAYING OPEN UNTIL 01.30 ESPECIALLY AS THE SHOP HAS BEEN VACANT FOR SOME CONSIDERABLE TIME & HAS NO CUSTOMER BASE AT ALL.

Crime and Disorder

COMMERCIAL/LICENSING

24 JUL 2015

PUBLIC PROTECTION DIVISION
222 UPPER ST. LONDON N1 1XR

1507/15

2017/15

<p>Protection of Children from Harm</p>
<p>Public Safety</p>

I wish my identity to be kept anonymous: Yes / No

We will treat representations as anonymous where there is a genuine reason to do so; if you wish your name and address details to be withheld then please explain the reason:

Copies of this representation will be sent to the applicant, or their agent/solicitor, including name and address details (but other personal contact information such as telephone numbers and email addresses will be removed) unless you have specifically requested anonymity. Copies of this representation will be included in a report that will be available to the public and will be published on the internet; however the published on-line version of the report will have name and address details removed.

Signature:

Date: 2017/15

Please ensure name and address details completed above

Return to: Licensing Service
London Borough of Islington
3rd Floor
222 Upper Street
London N1 1XR

or send by email to: licensing@islington.gov.uk

4

Fitzsimons, Aiden

From:
Sent: 22 July 2015 13:35
To: Licensing
Subject: WK/201590826

Ref WK/201590826
Pizza Takeaway, Unit A, Charles Morton Court, 37 Green Lanes, London, N16 9BS

Public Nuisance

Whilst I am supportive of new and existing businesses on this stretch of Green Lanes between Newington Green and Clissold Park we do have ongoing issues with regards to noise and anti-social behaviour. It should be noted that this part of the street is a mix of residential and business use with the majority being residential and therefore businesses operations should be sympathetic towards residents.

I am greatly concerned about the noise that will be generated with regards to the activity of the business, particularly with customers and delivery drivers coming and going using cars and mopeds to deliver pizzas. I therefore strongly object to the proposed extended hours of operation until midnight on Sunday-Thursday and 01:30am on Friday and Saturday night. I would recommend that the opening hours match the Tesco in the adjacent premises which is 11pm. Having lived opposite for several years I have found this closing time to be at the time limit with regards to noise generated, particularly on a work day night but also with regards to a peaceful weekend.

Crime & Disorder

I would be concerned about people loitering around the premises and causing noise and disruption, particularly being open near to the closing time of the nearby pubs. We already have issues with begging outside Tesco which dissipates once it closes, so again any extended hours would just serve to encourage these issues.

Protection of Children from Harm

A good number of residences on the road have young children. We already experience noise disruption such as people shouting in the street, deliveries to Tesco prior to opening hours, and traffic noise. Any extended hours of operation will only cause more disruptive noise and subsequent disturbance to children and this should be avoided.

I wish my identity to be kept anonymous. This is because this section of Green Lanes has well reported problems with some business operations and as I do not know who is proposing to open this outlet I wish to remain anonymous.

Thank you for the opportunity to place our concerns with regards to this application.

Regards,

Suggested conditions of approval consistent with the operating schedule

1. Notices will be displayed advising customers to leave the premises quietly.
2. A regular litter patrol shall service the local vicinity.
3. CCTV shall be installed and operated at the premises.

Conditions proposed by the Noise Service

4. Deliveries and waste collections shall occur between 7am and 9pm , Mondays to Saturdays, and between 10am and 6pm on Sundays.
5. Notices shall be conspicuously displayed in the shop requesting customers to leave the premises quietly.
6. No noise and vibration shall emanate from the premises to cause a nuisance to adjacent properties.

Title :

Islington Borough
Boundary

Printed by :
RO RO

Printed at :
17-08-2015

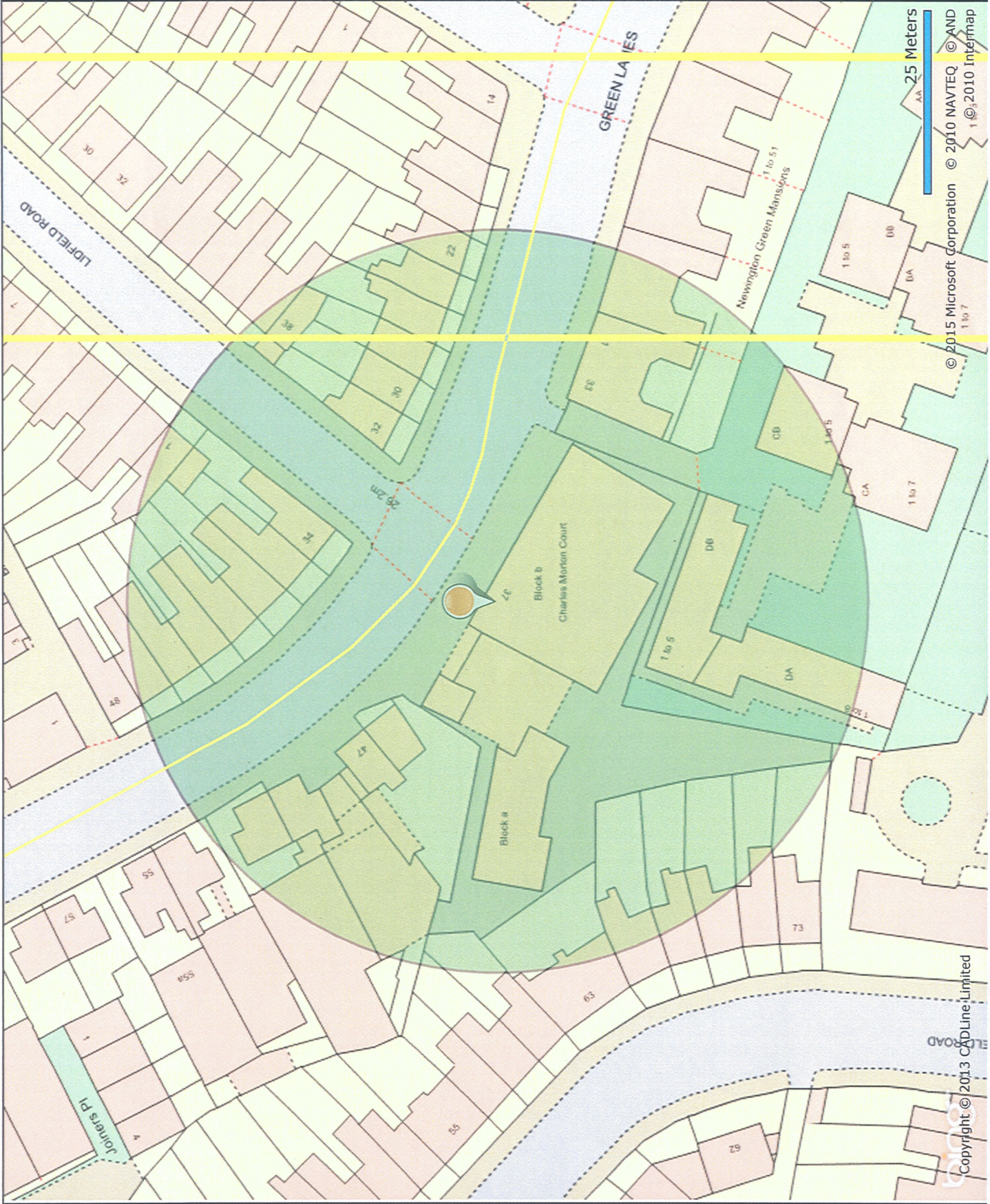
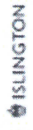

© 2015 Microsoft Corporation © 2010 NAVTEQ © AND
© 2010 Intermap

Copyright © 2013 CADLine Limited